

PS

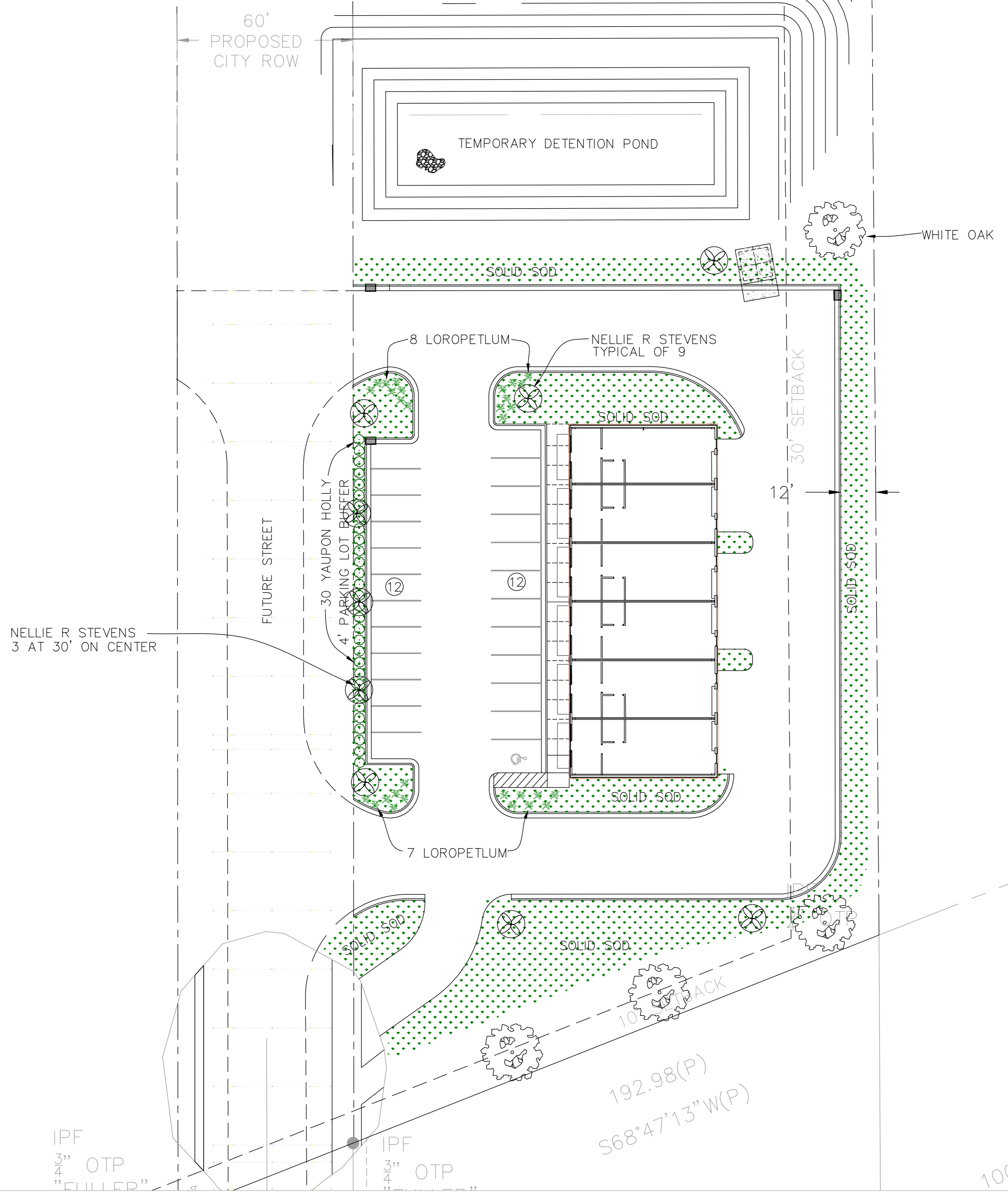

LEGEND:

- PROPERTY LINE
- BUILDING SETBACK
- EXISTING EASEMENT
- DISTURBED LIMITS
- EXISTING LANDSCAPED AREA
- EXISTING STORM SEWER
- EXISTING TREE
- ASPHALT
- SOD
- LANDSCAPING
- EXISTING TREE REMOVED

SQUARE FOOTAGE OF DEVELOPED AREA	46,000 SQ. FT.		
BASE POINTS REQUIRED	120	BASE POINTS OBTAINED	89
PARKING LOT POINTS REQUIRED	24	PARKING LOT POINTS OBTAINED	60
TOTAL POINTS REQUIRED	144	TOTAL POINTS OBTAINED	149
RESIDENTIAL BUFFER REQUIRED	---		
PARKING LOT BUFFER REQUIRED	YES		

PARKING LOT POINTS (including Buffer)					
SCIENTIFIC NAME	COMMON NAME	QUANTITY	CALIPER (SIZE)	POINTS	SYMBOL
ILEX VOMITORIA 'NANA'	DWARF YAUPON HOLLY	30	3 GALLON	30	☉
LOROPETLUM CHINESE VAR REBRUM	LOROPETLUM "PLUM DELIGHT"	30	3 GALLON	30	✱
TOTAL PARKING LOT POINTS =				60	
BASE POINTS					
ILEX X 'NELLIE R. STEVENS'	NELLIE R. STEVENS HOLLY	9	1.25"-1.5"	45	⊗
QUERCUS ALBA	WHITE OAK	4	2" - 2.5"	44	☉
TOTAL BASE POINTS =				89	

NOTE: FINAL LANDSCAPE DESIGN BY OWNER SELECTED LANDSCAPER. PLANT SELECTIONS MUST MEET THE REQUIREMENTS SET BY THIS PLAN AND THE CITY OF OPELIKA LANDSCAPE ORDINANCE.

LANDSCAPE NOTES:

- ALL DISTURBED AREAS NOT TO BE SURFACED OR LANDSCAPED, SHALL HOST SOLID STAND OF SOD (BERMUDA) WITH 4" TOP SOIL.
- IRRIGATION SYSTEM TO BE DESIGNED AND INSTALLED BY LANDSCAPE CONTRACTOR. TYPICAL COMPONENT DETAILS ARE INCLUDED ON SHEET C6.1

HARMON ENGINEERING & CONTRACTING CO., INC.
 ENGINEERING · CONTRACTING · ENVIRONMENTAL MANAGEMENT
 13376 C.L. Tothert, Jr. Parkway / LeFayette, Alabama 36862
 (334) 864-9135 / FAX (334) 864-8046

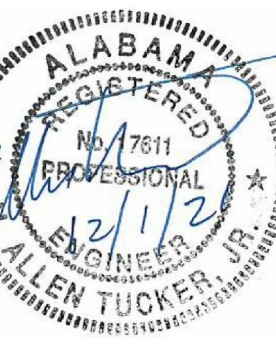
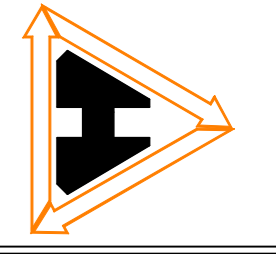

NO.	DATE	DESCRIPTION
1	2.12.2021	FOR CITY APPROVAL

LANDSCAPE PLAN
 ADAMS COMPLEX
 CLARK - ADAMS INVESTMENTS LLC
 OPELIKA, AL

DRAWN	MRA
CHECKED	MAT
FILENAME	DRIVE\FOLDER\DRAWINGS
DRAWING NAME	NAME.DWG
DATE	02 DEC 2021
PROJECT	782-25-21
SCALE	1" = 20'-0"
FIGURE	L1.0

